



RIVAL

COMPONENTS

1520 COMMERCE ST UNIT E, CORONA CA., 92880 P: (951) 261-5051
RIVALCOMPONENTS.COM

CRASH BARS

2020-21 YAMAHA TENERE 700



Please read through the installation instructions before installation of the product. If you have any doubts as to your ability to install the product, please consult your local motorcycle dealer to have the product installed professionally.

Where noted all fasteners should be torqued to the specifications noted in the installation instructions. All work should be performed on a suitable flat surface, center stand or service lift. Rival Components warrants that this product carries a warranty for 1 year from date of purchase against original defects in material and workmanship. Should this product fail to perform for either of the above reasons, Rival Components will repair or replace it with an equivalent product at no charge. To obtain the benefits of this warranty, the retail purchaser must send the product with proof of purchase to Rival Components.

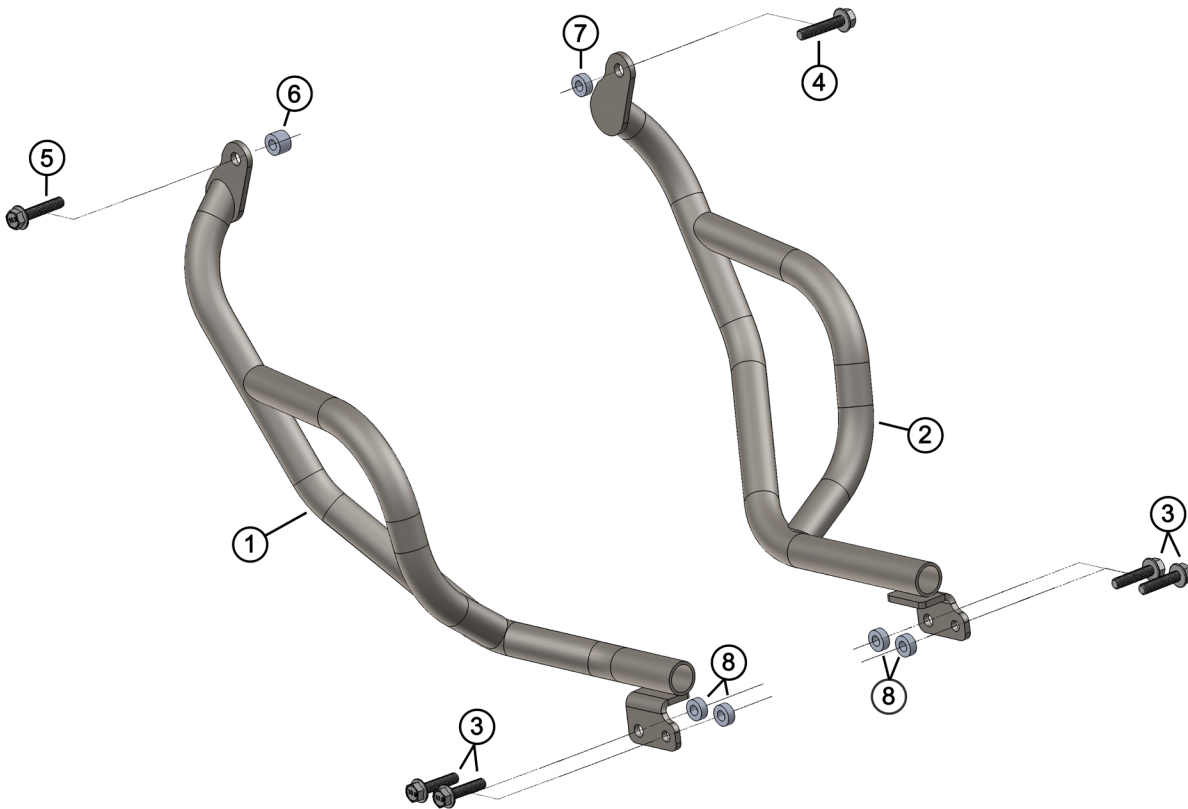

N0.	Description	Qty.
1	LHS Lower Crash Bar	1
2	RHS Lower Crash Bar	1
3	M8 x 1.25 x 35mm Flange Head Bolt	4
4	M8 x 1.25 x 40mm Flange Head Bolt	1
5	M8 x 1.25 x 45mm Flange Head Bolt	1
6	16mm x 8.4mm x 13mm Spacer	1
7	16mm x 8.4mm x 6.4mm Spacer	1
8	16mm x 8.4mm x 5mm Spacer	4

Left side crash bar

1. Remove the two lower sub-frame bolts.



2. Remove the lower of the two bolts from the upper sub-frame bolts.



3. Attach the crash bar using the 8mm x 13mm spacer and the 8mm x 45mm bolt. Install the spacer between the sub-frame and the crash bar mounting tab.

4. Attach the lower mounting tab using the two 8mm x 5mm spacer and 8mm x 35mm bolts. Install the spacer between the frame and crash bar mounting tab.

Right side crash bar

1. Remove the two lower sub-frame bolts.



2. Remove the lower of the two bolts from the upper sub-frame bolts.



3. Attach the crash bar using the 10mm x 6mm spacer and the 8mm x 40mm bolt. Install the spacer between the sub-frame and the crash bar mounting tab.

4. Attach the lower mounting tab using the two 8mm x 5mm spacer and 8mm x 35mm bolts. Install the spacer between the frame and crash bar mounting tab.

Torque all bolts to 25lb/ft (34N/m)